

"Underground Garage" with Protectodrain® PD 250

Detail:
Expansion Joint

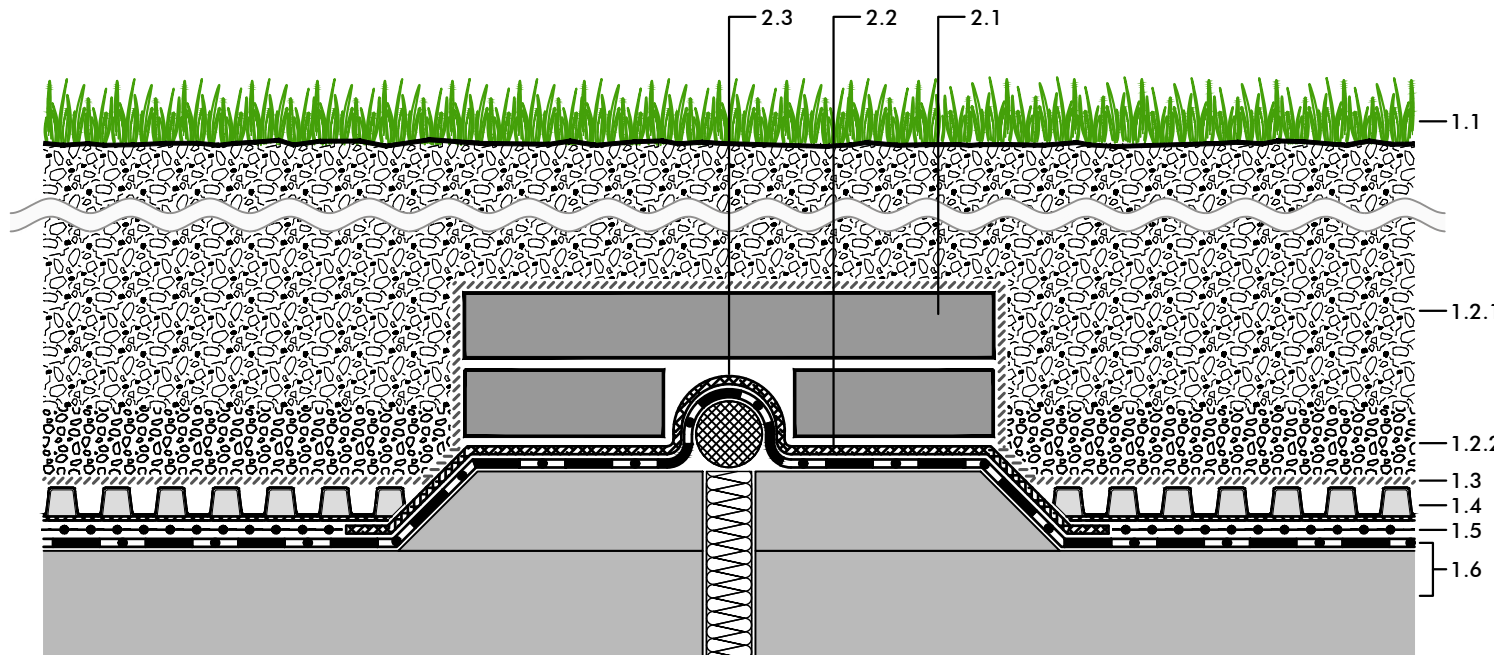

System build-up

- 1.1 Lawn, perennials, with sufficient substrate depth also shrubs and small trees
- 1.2.1 System Substrate "Roof Garden" or System Substrate "Lawn", 200 - 350 mm
- 1.2.2 Zincolit® Plus as sub-substrate for total substrate depth exceeding 350 mm
- 1.3 Filter Sheet TG
- 1.4 Protectodrain® PD 250
- 1.5 Slip Sheet TGF 20
- 1.6 Roof construction with root resistant waterproofing

Note:

The detailed solution shown here refers mainly to the ZinCo System Build-up. The roof construction itself as well as any other constructions are shown schematically and must be planned according to the relevant standards and guidelines.

Project:

-

Version:	Reviewed:	Scale:	Size:
10.12.2018	JGI / EVo -	none	A 4
Dehn01_Int_PD250_Fd.dxf			

Authorized by ZinCo GmbH, Lise-Meitner-Str. 2,
72622 Nuertingen/ Germany; Tel: +49/7022-6003-0
info@zinco-greenroof.com; www.zinco-greenroof.com

Subject to technical alterations and printing errors.



- 2.1 Concrete slabs
- 2.2 Protection mat (e.g. Protection Mat ISM 50)
- 2.3 Expansion joint

Additional notes:

- The location of the expansion joints can be marked e.g. by stepping stones.
- In order to avoid any differences in the appearance of the vegetation, the substrate depth above the expansion joint can be adjusted.